

# MEMBER BENEFIT REVIEW

---

---

May 11, 2021





# Today's Presenters



Duncan Proctor, Education & Training Strategist

Gerry Rasel, Membership Manager



Deanne Rider, Community Relations Manager

# SUBMIT A QUESTION

- Find the Q&A button on the control bar and type a question
- Logistical questions will be answered in Zoom
- Questions on the presentation will be answered during the Q&A Session (time permitting)

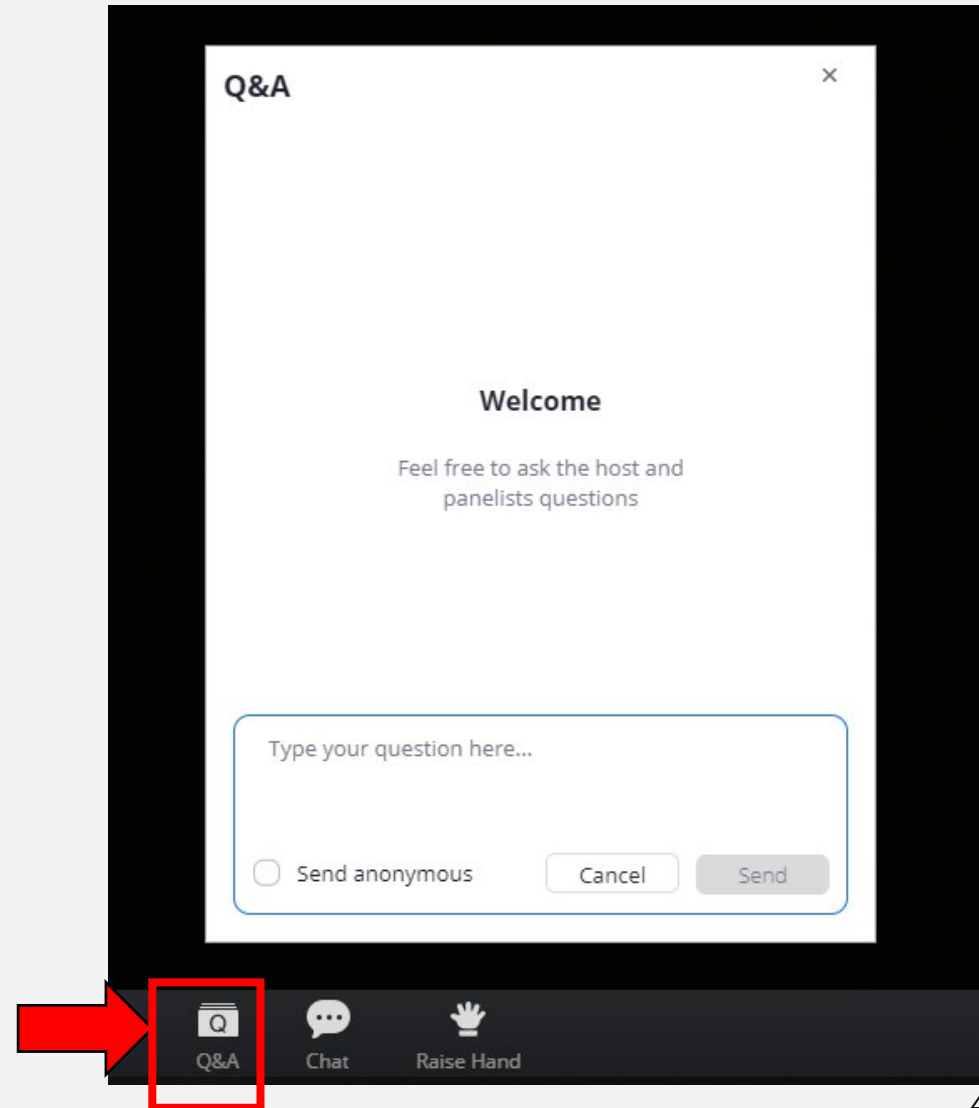



# About SEG



Established December 28, 1920, SEG is an international, member-based, scientific organization dedicated to advancing the science, discovery, and responsible development of mineral resources.

The Society's membership includes representatives from industry, academia, and government institutions.



# Staff: Administration



**Brian Hoal**  
Executive Director  
brianhoal@segweb.org



**Frances Kotze**  
Manager Events,  
Publication Sales &  
Marketing, Volunteer &  
Committees  
franceskotze@segweb.org



**Jeff Doyle**  
Website/IT Coordinator  
jeffdoyle@segweb.org



**Anna Thoms**  
Accounting  
annathoms@segweb.org

# Staff: Publications



**Alice Bouley**  
Managing Editor  
alicebouley@segweb.org



**Myra Holmes**  
Assistant Editor  
myraholmes@segweb.org



**Laura Doll**  
Graphic Design  
lauradoll@segweb.org



**Morgan Roy**  
Assistant Editor  
morganroy@segweb.org



# Staff: Education | Membership | Outreach | Student Services



**Duncan Proctor**  
Strategist for  
Education and Training  
[duncanproctor@segweb.org](mailto:duncanproctor@segweb.org)



**Deanne Rider**  
Community Relations  
Manager  
[deannerider@segweb.org](mailto:deannerider@segweb.org)



**Gerry Rasel**  
Membership Manager  
[gerryrasel@segweb.org](mailto:gerryrasel@segweb.org)



**Vicky Sternicki**  
Student Services Coordinator  
[vickysternicki@segweb.org](mailto:vickysternicki@segweb.org)



# Let's Chat Membership



Membership Categories designed to serve individuals across their career spectrum:

- Students
- Recent Graduates
- Professional
- Fellows
- Senior Fellow

# All Members:

- Enjoy a community of diverse and experienced professionals from industry, academia and governmental institutions;
- Have access to education and training that includes career-focused workshops, webinars and conference;
- Enjoy subscriptions to industry-leading scholarly publications including *Economic Geology* and *SEG Discovery*;
- Receive at least 20% off list price on all publications at the SEG Store and access to member-only publication sales;
- Receive discounted pricing on scientific conferences.
- May participate in our mentoring program – be a mentor or be mentored



# Membership: *Student*

Eligibility: Available to full-time undergraduate or graduate students enrolled and majoring in geology or earth-science program.\*

Cost: US \$25 annually; all subscriptions are electronic

\* *Enrollment verification required*



# Additional Benefits of Student Membership

- SEG offers various **student research grants** and fellowship **awards** that vary in size beginning at \$1,000.\*
- Only student members of SEG may apply to our Student Field-Trip Program. **Limited to 16 students per trip**, this highly-competitive program is led by SEG members. **Transportation and lodging costs are covered by the SEG Foundation.**

\* *Certain restrictions apply. Visit [website](#) for details.*





# Membership: *Recent Graduate*



Let's ease into the transition....

Eligibility: Available to individuals transitioning from their role as student to new adventures in areas such as industry, academia, or government. \*

Cost: US \$50 annually; all subscriptions are electronic

*\* A one-year-only membership. Must have been an SEG Student Member to qualify.*



# Membership: *Professional*

Eligibility: Available to professionals with a degree in geology and/or earth-science program and relative work experience.

Cost varies based on member selection:

<b>Electronic Only</b>  <b>US \$100 annually</b>	<b>Electronic + Print Newsletter</b>  <b>US \$135 annually</b>	<b>Electronic + Print Newsletter + Print Journal</b>  <b>US \$195 annually</b>
<p>Online Access:</p> <ul style="list-style-type: none"> <li>▪ <i>Economic Geology</i></li> <li>▪ <i>SEG Discovery</i></li> <li>▪ SEG Millennium Edition, powered by Geofacets</li> </ul>	<p>Online Access:</p> <ul style="list-style-type: none"> <li>▪ <i>Economic Geology</i></li> <li>▪ <i>SEG Discovery</i></li> <li>▪ SEG Millennium Edition, powered by Geofacets</li> <li>▪ Mailed Print Versions: <i>SEG Discovery</i></li> </ul>	<p>Online Access:</p> <ul style="list-style-type: none"> <li>▪ <i>Economic Geology</i></li> <li>▪ <i>SEG Discovery</i></li> <li>▪ SEG Millennium Edition, powered by Geofacets</li> <li>▪ Mailed Print Versions: <i>SEG Discovery</i> <i>Economic Geology</i></li> </ul>



# MEMBERSHIP: *Fellow*

Eligibility: Open to all geoscience graduates holding at least a bachelor's degree. Additional requirements include:

- Eight years (minimum) of professional experience
- Five years (minimum) of work principally devoted to economic geology, three of which must have been in positions of responsibility

Consideration will be given to work of an individual in research or as a teacher of economic geology.

*Note: An applicant must be sponsored by two SEG Fellows.*



# Membership: *Fellow Pricing*

Cost varies based on member selection:

Electronic Only	Electronic + Print Newsletter	Electronic + Print Newsletter + Print Journal
US \$100 annually	US \$135 annually	US \$195 annually
Online Access: <ul style="list-style-type: none"><li>▪ <i>Economic Geology</i></li><li>▪ <i>SEG Discovery</i></li><li>▪ SEG Millennium Edition, powered by Geofacets</li></ul>	Online Access: <ul style="list-style-type: none"><li>▪ <i>Economic Geology</i></li><li>▪ <i>SEG Discovery</i></li><li>▪ SEG Millennium Edition, powered by Geofacets</li><li>▪ Mailed Print Versions: <i>SEG Discovery</i></li></ul>	Online Access: <ul style="list-style-type: none"><li>▪ <i>Economic Geology</i></li><li>▪ <i>SEG Discovery</i></li><li>▪ SEG Millennium Edition, powered by Geofacets</li><li>▪ Mailed Print Versions: <i>SEG Discovery</i> <i>Economic Geology</i></li></ul>





# Why Become a Fellow?



Enhance your professional status – place your status on your business card



Only Fellows are eligible to serve on some SEG committees or board – expand your professional network



Sponsor other professionals looking to become a part of SEG

# MEMBERSHIP: *Senior Fellow*

Eligibility: Fellows of the Society who have paid dues for 30 years and who are at least 70 years will be “Senior Fellow” and will receive SEG Discovery at no charge.



# Let's Chat Education & Training

- SEG is committed to delivering world-class programs that provide opportunities to further professional development and build skills in mineral deposit geology and exploration
- SEG Members receive preferred pricing on workshops, short courses, and the SEG annual conference



# Education & Training: Webinars/Lectures/Panel Discussions

- Discussions on wide-ranging topics of relevance
- Specific themes that matter most to students and early career professionals
- Archived events available on-demand





# Education & Training: Workshops & Short Courses

- Covering a broad range of themes, ranging from geology specific technical offerings to exploration methods and project management style classes
- Strong focus on relevant subjects and critical industry skillsets



**SEG**  
www.segweb.org

**Short Course on  
Orogenic Gold in  
Africa and Worldwide**

The University of Cape Town |  
Rondebosch, South Africa  
February 3–4, 2018

**DESCRIPTION**



# Education & Training: Field Trips

- Economic geology focused field trips led by world-class experts to metallogenic provinces around the globe
- Michael J. Fitzgerald Student Mapping Course offered several times a year for students looking to hone critical field mapping skills





# Education & Training: Virtual Field Trip Initiatives

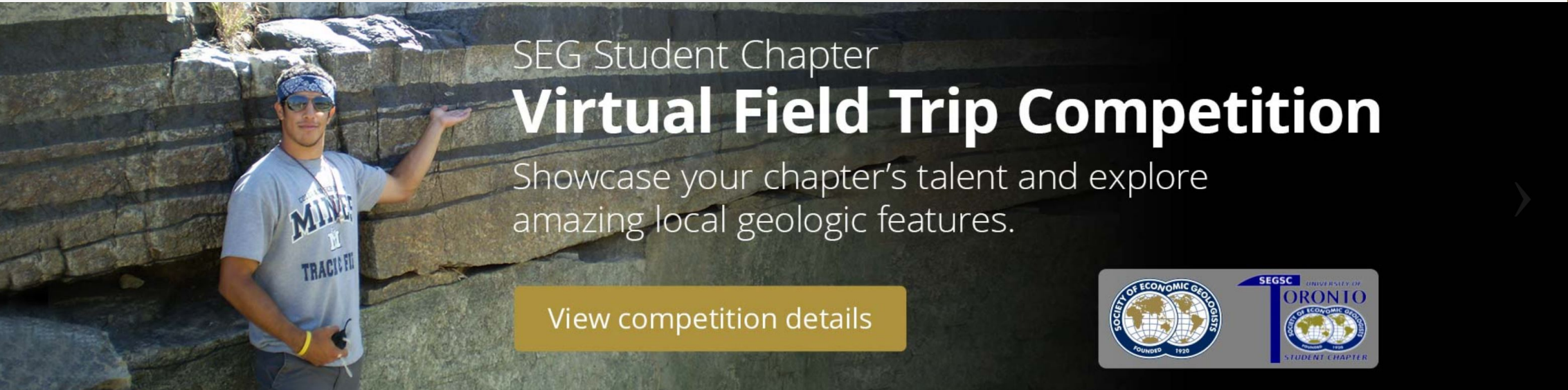

## SEG Student Chapter Virtual Field Trip Competition

Showcase your chapter's talent and explore amazing local geologic features.

[View competition details](#)



- Student Chapter Virtual Field Trip Competition
- Archived database of growing economic geology trips from around the globe



# Education & Training

## Students and Early Career Professionals

- Provided specialized training and opportunities for job hunting, navigating industry, and developing vital technical and managerial skill sets
- Benefit from networking and collaborating with experienced SEG members throughout the mining and exploration industry

## Professionals

- Benefit from our world-class offerings and continue to foster professional development through a wide array of education and training initiatives

*SEG provides geoscientists with the skills, knowledge and training to succeed and grow in their careers!*





# Let's Talk Publications



Premier periodicals in the field of economic geology that will educate and advance your professional knowledge.

©

# Publications: *Economic Geology*

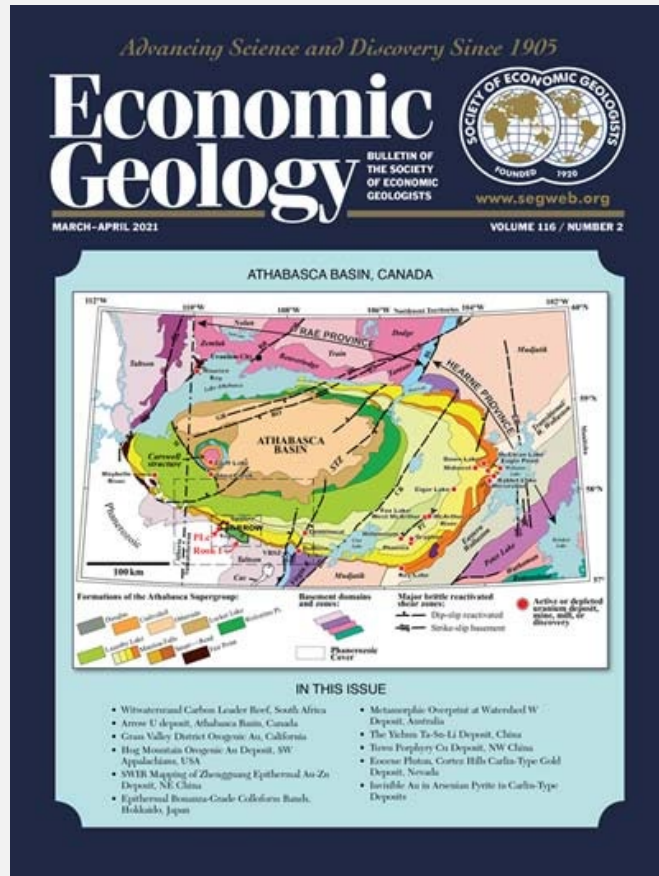

- A highly-technical journal is published eight times a year and contains the latest in research and data.

*Available electronically or printed*



# Publications: *SEG Discovery*

- A quarterly periodical with industry-focused articles, technical news and member updates.

*Available electronically or printed*

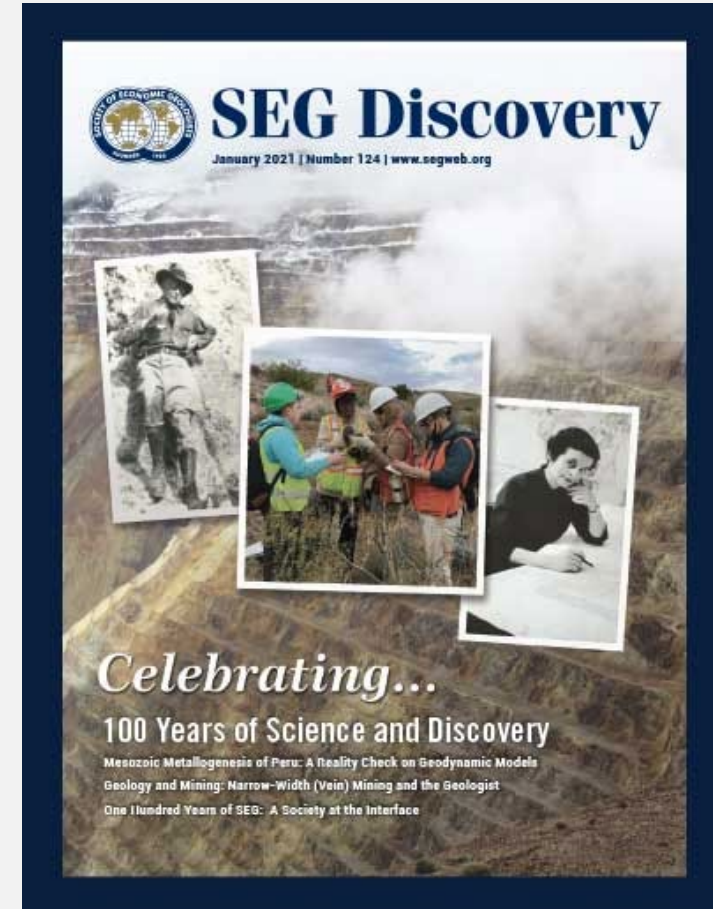

# More Publications



- Special Publications: occasional publications covering a wide range of themes in economic geology
- Reviews in Economic Geology: publications that survey past and current understanding of relevant topics
- Field trip guidebooks: provide background information, maps, and specific routes with highlighted stops for trips through historic and current important areas of exploration and mining activity.



# SEG Conference



Whether in person or virtual, this is *the* conference to discover new science and thinking. This intimate event allows for networking and sharing of ideas.

Special roundtable discussions for students and early career professionals focusing on:  
mentorship | education |  
managing change | work and family balance | and more.....





# SEG 100 Conference

Celebrating a Century of Discovery

Whistler, Canada • September 14–17, 2021

Hybrid Event – all content online

Registration  
Opens  
Late May, 2021



SEG100.ORG #SEG100

- Game changers – the first hundred years
- Lindgren’s legacy – ore deposits in depth
- Gold 2020 – golden past, precious future
- Basins through time – linking process and ore systems
  - Ore deposit structure – processes, patterns, and innovations
  - Beyond 2021 – the next hundred years
- Tectonomagmatism and porphyry-epithermal metallogeny (Tribute to Jeremy P. Richards)
  - Diversity in ore deposits

# Let's Talk Community

With members worldwide, being a part of SEG allows you to be part of a vast network of peers with whom you can share ideas, ask questions – be engaged!

**Coming later this year:**  
An online community exchange forum exclusively for SEG members.

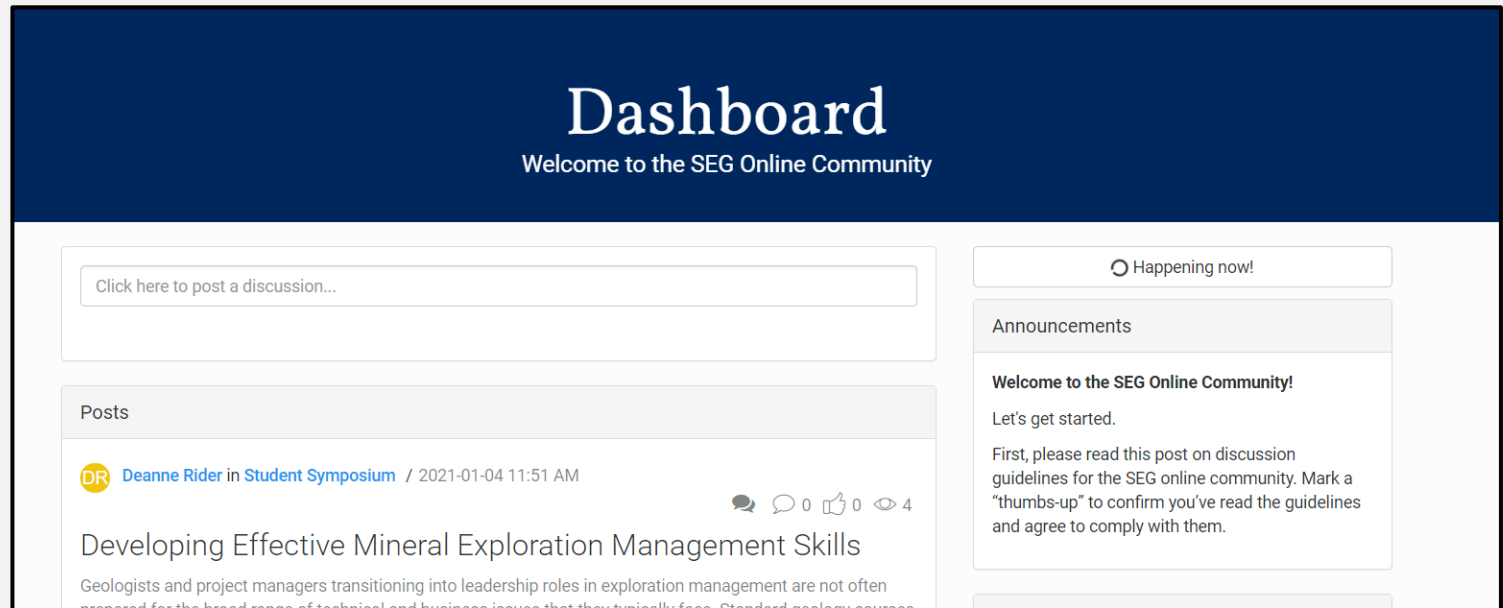

The screenshot shows the 'Dashboard' for the SEG Online Community. At the top, it says 'Welcome to the SEG Online Community'. Below this is a search bar with the placeholder text 'Click here to post a discussion...'. To the right, there is a toggle for 'Happening now!'. The main content area is divided into 'Announcements' and 'Posts'. The 'Announcements' section features a post titled 'Welcome to the SEG Online Community!' with the text 'Let's get started. First, please read this post on discussion guidelines for the SEG online community. Mark a "thumbs-up" to confirm you've read the guidelines and agree to comply with them.' The 'Posts' section shows a post by 'Deanne Rider' in the 'Student Symposium' category, dated '2021-01-04 11:51 AM'. The post title is 'Developing Effective Mineral Exploration Management Skills' and the beginning of the text reads 'Geologists and project managers transitioning into leadership roles in exploration management are not often...'. Interaction icons for comments, replies, likes, and views are visible next to the post.

# Together We.....



As an SEG member you are able to volunteer for committees like the Early Career Professionals, Students, and more! This experience:

- Allows for superb networking opportunities
- Helps develop leadership and teamworking skills
- Increases personal visibility
- Provides an opportunity for experienced professionals to give back - mentoring, and more!



# Refer a Colleague

Who do you know that should be a member of SEG? Look for an exciting announcement introducing our Refer-a-Colleague program



# Supporting SEG

Shopping online with Amazon? Visit [smile.amazon.com](https://smile.amazon.com) and select SEG as your charity of choice. AmazonSmile is the same Amazon you know. Same products, same prices, same service. But utilizing AmazonSmile means Amazon will donate .5% of the price of your eligible purchases to the SEG New Century Fund.

SEG New Century Fund: Supports education and training programs with a focus on students and early career professionals to build diversity and inclusion in a new generation of mineral explorers.





# Questions?



# Thanks Again...and a Closing Thought



*"Exploration is the engine that drives innovation. Innovation drives economic growth. So let's all go exploring."*

-Edith Widder,  
oceanographer, marine biologist